

## MDC-BL-58

The MDC-BL-43, especially designed for applications where high torque to volume ratio is needed, is a brushless DC motor with rare-earth/cobalt magnet rotor and Hall effect rotor position sensor. Peak torque obtained on the axis at nominal voltage of 28 VDC is 350 mNm. An important feature is its low cogging torque, allowing smooth motion across the whole range of speeds. MDC-BL-43 conforms to MIL-STD. Operating temperature range: -40 to +80 °C. Vibration toleration: according to MIL-STD-810.



## Specifications

Parameter	Unit	Value	Tolerance
Operatig voltage	VDC	48	-
Peak torque	Nm	7.5	min.
Winding resistance	Ohm	0.45	±10%
Winding inductance	mHy	0.2	±30%
No load current	A	0.8	-
No load speed	rpm	4400	-
BEMF constant	V/rad/s	0.103	-
Cogging torque	Nm	0.080	max.
Stall torque	Nm	10	max.
Torque constant	Nm / A	0.103	-
Winding to case dielectric resistance, @ 250 VDC	MOhm	100	min.
Hall effect sensor circuits to case dielectric resistance, @ 100 VDC	MOhm	50	min.
Operating temperature range	°C	-40 - +80	
Dimensions	mm		-
Length		100	
Flange outlet		4	
Flange diameter		25	
Outer diameter		63	
Width		58 x 58	
Weight	kg	1.400	-

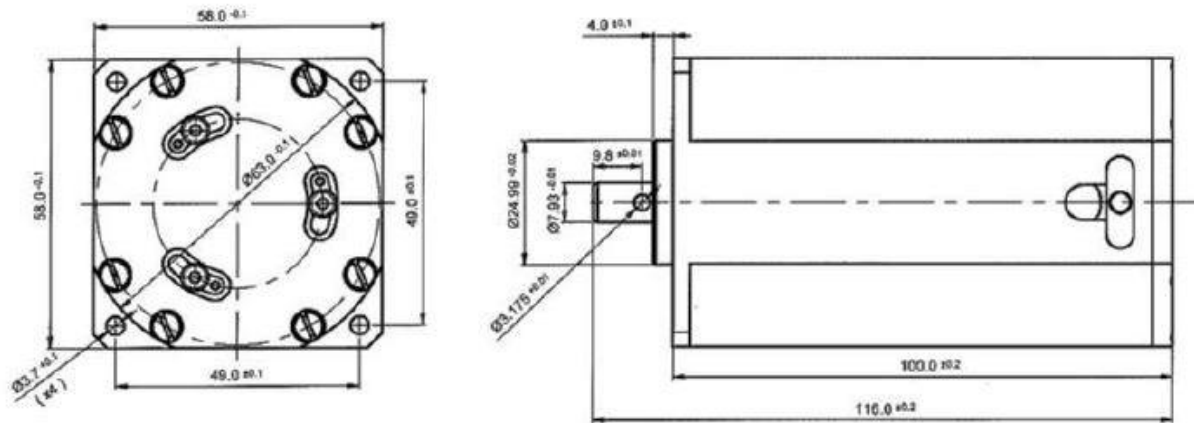
**MDC-BL-58****Drawing**

*All dimensions are in mm*

**For Additional Information**

To learn more about the MDC-BL-58 or other MTC products, contact MTC on **+972 4 998 7772** or email **[marketing@mtcind.com](mailto:marketing@mtcind.com)**